

## Ultrasonic Tongue & Groove Shear Joint - Single

Customer Name: \_\_\_\_\_ Date: \_\_\_\_\_

Application Number: \_\_\_\_\_ Revision: \_\_\_\_\_

Project: \_\_\_\_\_

Material: \_\_\_\_\_

Prepared By: \_\_\_\_\_ Email: \_\_\_\_\_

	Dimension	General Guidelines	Recommended Size
W	Wall Thickness	Minimum 0.090" (2.29mm)	
B	Shear Length	Approximately 0.030" (0.76mm)	
A	Shear Width	0.008" - 0.020" (0.20mm - 0.51mm)	
T	Tongue Width	W/3	
H	Tongue Height	W/3	
G	Groove Width	(T - A) + C	
D	Groove Depth	H + 0.015" (0.38mm)	
L	Lead-in	Minimum 0.020" (0.51mm)	
S	Groove Side Wall Width	Minimum 0.035" (0.89mm)	
C	Clearance	0.002" to 0.004" (0.05mm - 0.10mm)	

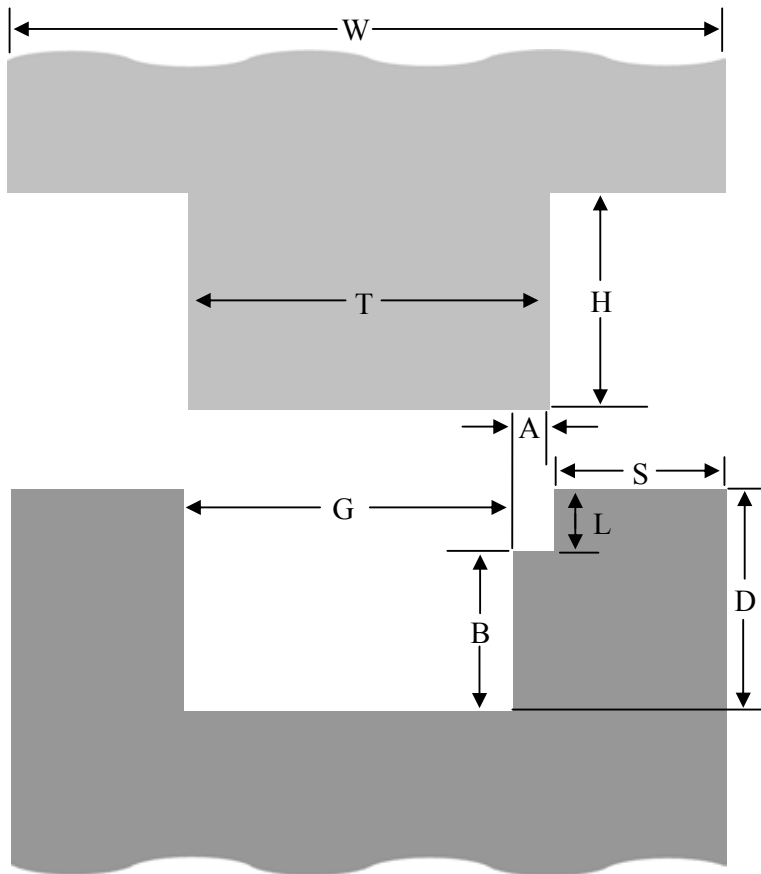

The tongue and groove single shear joint for ultrasonic welding is used to obtain a strong, leak-tight weld on parts smaller than 2" (50.8mm) in diameter or length.

When using this type of joint, it is very important to ensure sufficient rigidity in the side walls. Otherwise, the joint may be weakened and the walls may deform or crack.

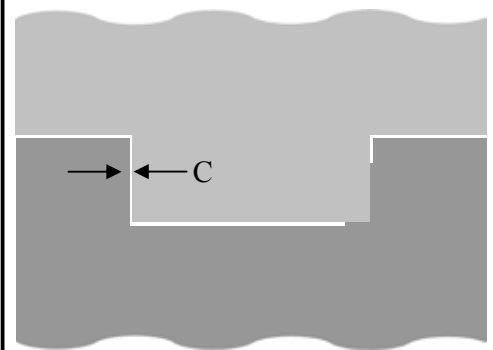

Collapsed

--

Part Name/Description

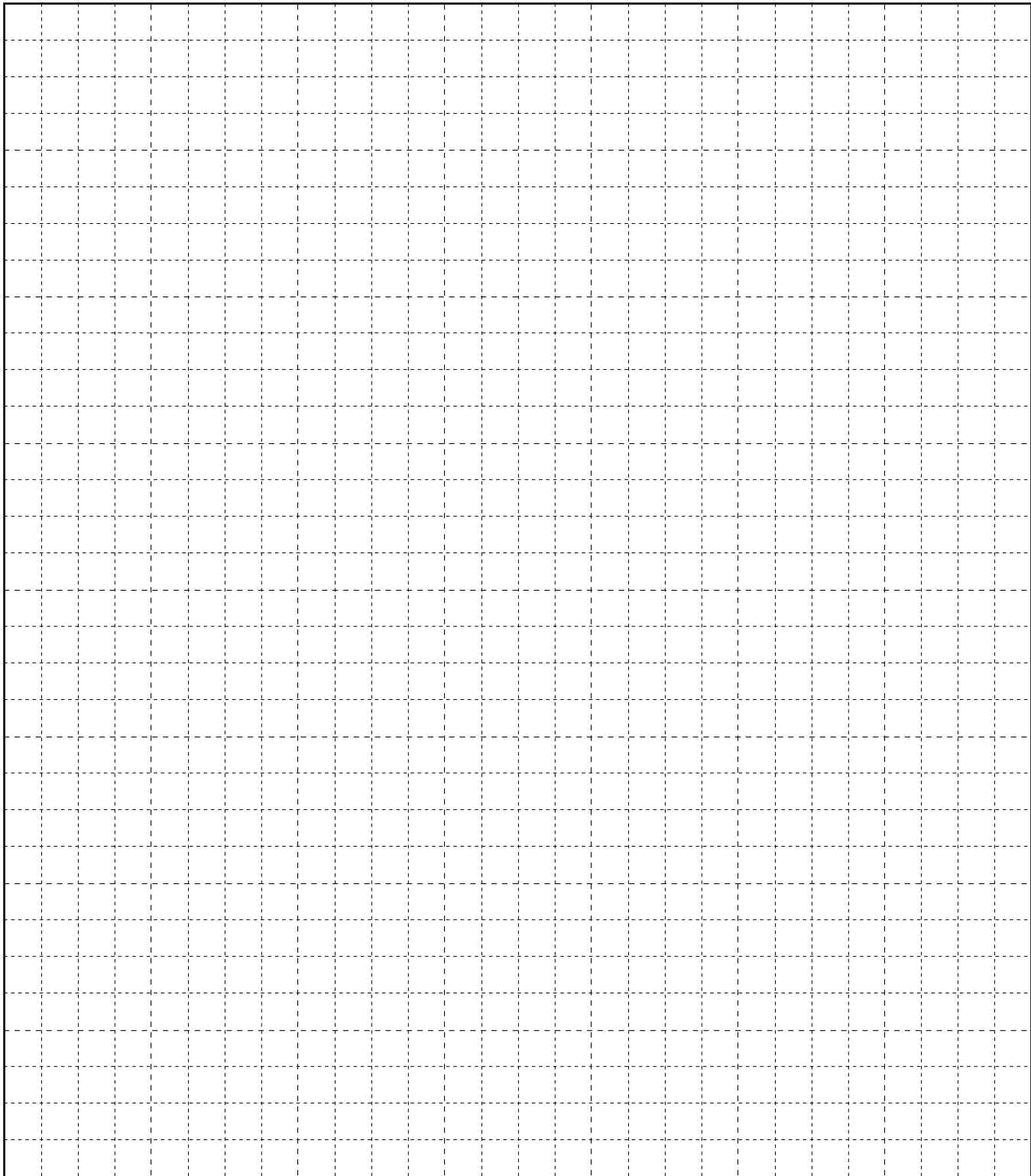

**Use this grid to sketch the specific part design showing joint dimensions and location.**